

Venus™

SEATED TREATMENT AND MASSAGE

The Athlegen Venus is suitable for a wide range of modalities, including massage and beauty treatments. The top configuration is designed so that the motorised backrest automatically tilts the seat, perfect for positioning clients in a totally relaxing reclined/seated position. The adjustable face cradle can be slightly lowered enabling the prone patient to fully relax the neck muscles giving optimum comfort - ideal for massage treatments.

The sturdy design helps to optimize your performance whilst achieving maximum comfort and support for your clients. Combine this with quiet height adjustment and you have discovered just a few reasons why this is the perfect table for your salon or spa. The Venus can be supplied with straight sides.



Shown with optional armrests, body/shoulder supports, and extensible footrest

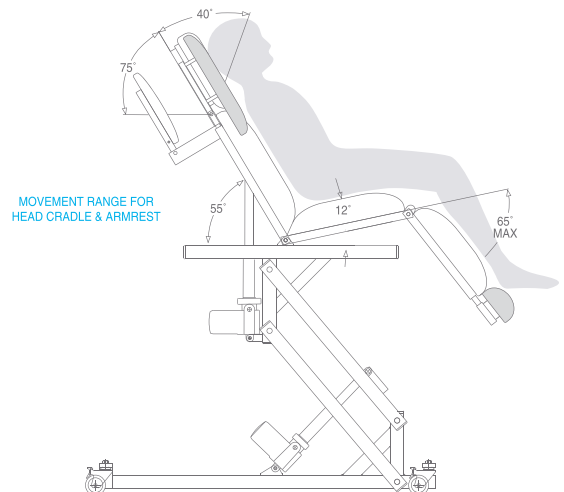
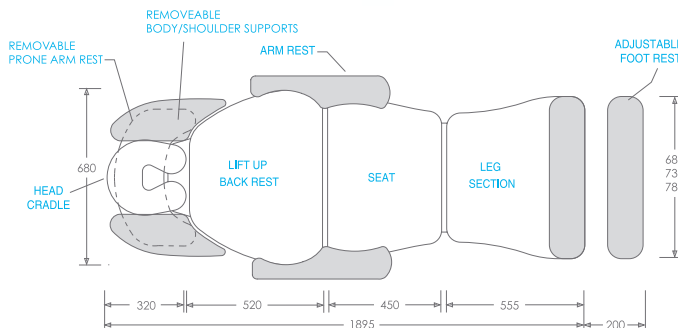

features

- Electric power height adjustment system is driven by a commercial grade linear actuator made in Germany, ensuring fast, reliable and vibration free performance.
- Power driven back rest and auto tilting seat section can be adjusted effortlessly as required during the treatment.
- 8 pivot lifting arm mechanism, super strong, with self lubricating nylon bushes to ensure smooth and quiet operation.
- Upholstery construction features special high density foam rubbers and incorporates soft edge technology.
- High quality protective coated vinyl with oil resistant properties; durable, with a soft and comfortable feel.
- Unique Access top design allows improved practitioner access during treatments while minimizing fatigue and discomfort.
- Heavy duty, industrial quality lockable castors with steel bearings and a rubber wheel tread.
- Durable powder coated rust resistant frame.
- Heavy duty stainless steel footswitch
- Built to last with very low maintenance.

specifications

- Maneuverability**
360° rotation, heavy duty industrial quality lockable castors.
- Covering**
PVC tested to AS 1441.11, AS 1530.3, AS 4088.1
- Cushioning**
CFC free, polyurethane foam
- Frame**
Powder coated, rust resistant steel frame
- Maximum working height**
1020mm (with standard foam)
- Minimum working height**
560mm (with standard foam)
- Maximum working load**
175kg
- Power requirements**
240 VAC @ 3.4 AMPS
- Table Length**
Length with extendable foot rest (in retracted position) 1895mm
Length with extendable foot rest (in the fully extended position) 2135mm
- Shipping dimensions**
1900mm x 800mm x 800mm
- Shipping weight**
125kg
- Warranty**
Australia 5 years structural and 3 years motor. Extended warranty available. Other countries upon request.

Free Call 1 800 813 000 www.athlegen.com



Official Supplier



Cushioning options

Through 20 years of working with practitioners in different modalities, Athlegen has developed a series of cushioning systems which can be matched to your choice of Athlegen table, and your treatment style.

A choice in cushioning systems allows you to choose between a range of options, delivering varying levels of quality, comfort and support. Take the time to carefully consider which system will best suit you, and your client's needs. Please don't hesitate to contact us if you require assistance.

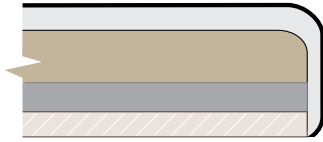

Standard cushioning

Consists of a firm base, medium centre and soft overwrap layer. This is our minimum standard of cushioning where comfort and support are a requirement. Overall thickness - 60mm

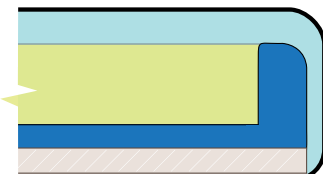

Enduro cushioning

Consists of a high density ultra firm base and side booster, medium enduro foam centre, and soft enduro overwrap layer. This is our premium standard of cushioning, and is highly recommended for massage. Overall thickness - 90mm

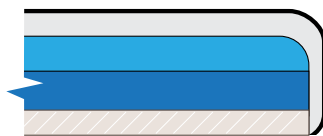

Firm Adjustment cushioning

Consists of a high density ultra firm base, medium firmness, high density centre and softer comfort overwrap. This cushioning system blurs the line between the soft comfort of Enduro 3 layer, and our firmest adjustment option. Recommended for firm to heavy treatment styles such as sports massage and Osteopathy. Overall thickness - 70mm

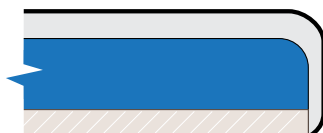

Ultra Firm Adjustment cushioning

The firmest grade of cushioning available, and is designed for heavy treatment and adjustment work. Cushioning consists of an ultra firm, high density base with a softer comfort overwrap. Recommended for firm and heavy treatment styles such as Osteopathy and Chiropractic. Overall thickness - 70mm

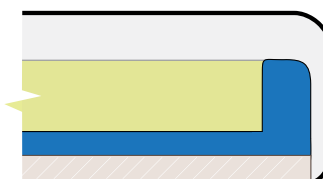

Luxura cushioning

Consists of a high density ultra firm base and side booster, medium enduro foam centre, and thick Luxura overwrap layer. This is our premium standard of cushioning for beauty and spa treatments. Overall thickness - 90mm

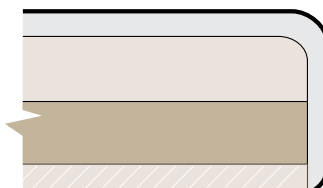

Beauty comfort cushioning

Consists of a high density base, medium density foam centre, and soft overwrap layer. This is our standard cushioning on the beauty lift MK II. Overall thickness - 110mm

Upholstery options

Athlegen has carefully selected upholstery fabrics designed to meet the demands of a busy practice and is proud to offer the following vinyl selection. Additional colour choices are available for an extra charge upon request. Please visit the Austex website for further information on colour available in the Pellan and Condor ranges- [click here](#)

Standard range - [Condor](#)



Dove

Teal

Burnt rose

Balmain

Condor is designed to have unlimited applications in heavy commercial environments. It complies with the highest standards in fabric quality, offering high resistance to normal scrapes and scuffing, where conventional vinyls have difficulty. Condor is formulated with PRIMUS, a technical breakthrough in vinyl protection - PRIMUS is an exclusive perspiration and oil resistant formulation, which helps inhibit cracking and drying out of the P.V.C. surface. This exclusive formulation delivers a superior softness for comfort, strength and wear characteristics. Condor is a low maintenance vinyl coated fabric with a refined surface texture and is available in a range of modern colours.

Premium range - [Pellan](#) (additional charge)



Black

White

Bone

Coco

Navy

A new generation of upholstery fabric designed to comply with the highest standards in heavy commercial applications. Pellan is formulated with Primus, a technical breakthrough in vinyl protection. Primus is an exclusive perspiration and oil resistant formulation, which helps inhibit cracking and drying out of the PVC surface. Pellan's revolutionary formulation guarantees, softness, durability and low maintenance. Available in a range of elegant colours and a refined leather look texture, designed to compliment today's imaginative styles.

Quality standards - [Pellan & Condor](#)

- > Exclusive formulation inhibits the hardening and breakdown of the PVC surface due to perspiration and oil.
- > A protective top surface allowing easy removal of difficult stains and dirt.
- > Smouldering cigarette will not ignite upholstery material: Burn test: (AS37441.1)
- > Meets Australian F.R standards for use in commercial areas: Flame retardant test (AS 1530.3)

Free Call 1 800 813 000 www.athlegen.com



Official Supplier

 **ATHLEGEN**[®]
Proudly Australian Made