

ATHLEGEN

Dermatology Range



1800 813 000
www.athlegen.com.au
sales@athlegen.com



"The table is perfect and I am really happy with the quality, material and colour. Your company made the whole process incredibly simple and efficient and delivered on time."

CAROLYN AUSTIN

Pro-Lift Treatment 680

This versatile three-section table is ideal for physiotherapy, massage, beauty treatments, examinations or any multimodality practice. The 680mm backrest configuration allows for more legroom when seated compared to the Treatment 930.

SELECT FROM OVER 30 COLOURS AND FABRIC CHOICES INCLUDING POLYURETHANE (PU), VINYL (PVC) AND GENUINE ITALIAN LEATHER:

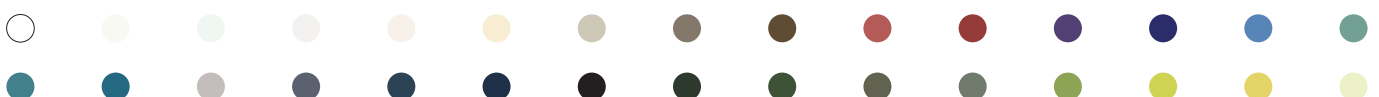

PRODUCT INFORMATION



MANUALLY ADJUSTABLE BACKREST

The lift-up back adjusts in seconds to create a sturdy, comfortable treatment platform – an ideal choice for massage, beauty treatments, examinations or any multimodality practice.

ADJUSTABLE HEAD SECTION

The standard configuration includes a face hole in the head section for more comfortable prone treatments. The head section can be finely adjusted to enable the prone patient to relax the neck muscles fully during treatments.

FACE HOLE OPTIONS

Choose a face recess in the lift-up back or head section. Order a face hole plug to help move patients quickly between prone and supine positions – no need to rotate the patient to avoid the face hole.



FOAM OPTIONS

Choose between five Dunlop® cushioning systems ranging from Ultra Firm to luxurious Viscoflex® slow release memory foam. We have the right foam system to suit your modality.

TABLE WIDTH

Select from three table widths to suit your modality. Custom width tabletops are also available at an additional cost.

BASE STYLE

Choose between our Standard base with concealed in-line wheels and floor-levelling feet or our lockable Castor base for easy manoeuvrability. All wheels feature TPE rubber compound tread to protect your floors.

KEY OPTIONS

	STANDARD	OPTIONAL	
DUNLOP CUSHIONING	55mm, medium finish	Enduro (70mm, firm finish) Luxura (80mm, luxurious finish) Firm (50mm, firm finish) Ultra Firm (50mm, very firm finish)	
BACKREST	Manually adjustable	N/A	
HEAD SECTION	Manually adjustable	N/A	
FACE HOLE	In the head section	In the backrest	No face hole
FACE HOLE PLUG	No face hole plug	Optional	
BASE STYLE	Concealed in-line wheels	75mm locking castors	
FOOTSWITCH	Single	One on each side of the table	
TABLE WIDTH	610mm	660mm	710mm

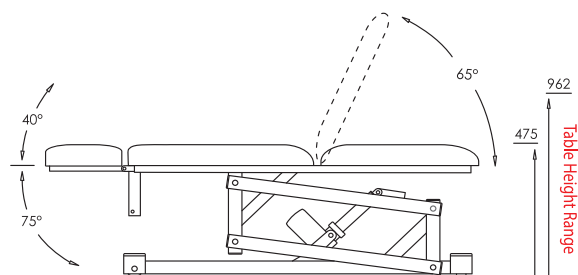
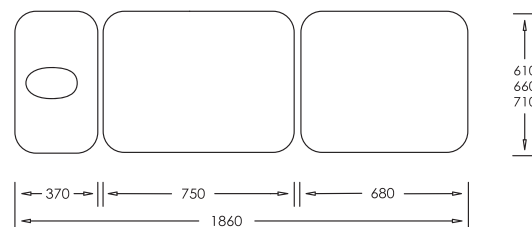

KEY SPECIFICATIONS

ADJUSTMENTS	Backrest: +65° Head section: +40° to -75°
SAFE WORKING LOAD	220kg
MOTOR	Lift force: 10,000N Speed: 37mm/sec Height adjustment (min to max): 487mm in 13 seconds Speed test load: 180kg
FOOTSWITCH	Ergonomic low profile design (20mm) Stainless steel Pneumatic control
SHIPPING	1930 x 730 x 720mm 125kg
WARRANTY	Structural: 15 years Hardware: 5 years Motor: 3 years Footswitch: 1 year Upholstery: To arrive in perfect condition

Athlegen is a brand of
Alevo Pty Ltd © 2019



All dimensions (shown in mm) and specifications are approximate and are subject to manufacturing tolerances.

#200305



"The table is perfect and I am really happy with the quality, material and colour. Your company made the whole process incredibly simple and efficient and delivered on time."

CAROLYN AUSTIN

Pro-Lift Treatment ABR

With a lift-up back, this versatile table is suitable for a wide range of modalities, including physio, acupuncture, massage, beauty treatments, examinations, or any multimodality practice.

SELECT FROM OVER 30 COLOURS AND FABRIC CHOICES INCLUDING POLYURETHANE (PU), VINYL (PVC) AND GENUINE ITALIAN LEATHER:



PRODUCT INFORMATION



MANUALLY ADJUSTABLE BACKREST

The Treatment ABR adjusts flat in seconds to create a sturdy, comfortable treatment platform. This versatile table is an ideal choice for massage or beauty treatments, examinations or any multimodality practice.

FAST HEIGHT ADJUSTMENT

Save time with quick height adjustments from our extra powerful 10,000N German actuator - with smooth and quiet operation, our actuator is three times faster than most competing products.

FACE HOLE OPTIONS

Choose a face recess in the lift-up back or main body section. Order a face hole plug to help move patients quickly between prone and supine positions - no need to rotate the patient to avoid the face hole.



FOAM OPTIONS

Choose between five Dunlop® cushioning systems ranging from Ultra Firm to luxurious Viscoflex® slow release memory foam. We have the right foam system to suit your modality.

TABLE WIDTH

Select from three table widths to suit your modality. Custom width tabletops are also available at an additional cost.

BASE STYLE

Choose between our Standard base with concealed in-line wheels and floor-leveling feet or our lockable Castor base for easy manoeuvrability. All wheels feature TPE rubber compound tread to protect your floors.

KEY OPTIONS

	STANDARD	OPTIONAL
DUNLOP CUSHIONING	55mm, medium finish	Enduro (70mm, firm finish) Luxura (80mm, luxurious finish) Firm (50mm, firm finish) Ultra Firm (50mm, very firm finish)
BACKREST	Manually adjustable	N/A
FACE HOLE	No face hole	In the main body In the lift-up back
FACE HOLE PLUG	No face hole plug	Optional
BASE STYLE	Concealed in-line wheels	75mm locking castors
FOOTSWITCH	Single	One on each side of the table
TABLE WIDTH	610mm 660mm	710mm

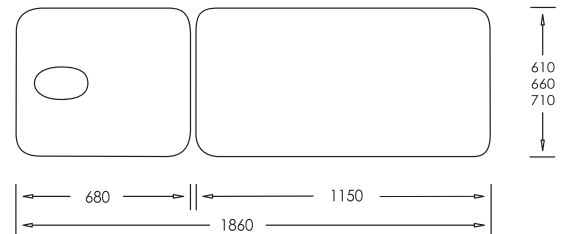

KEY SPECIFICATIONS

ADJUSTMENTS	Backrest: +65°
SAFE WORKING LOAD	220kg
MOTOR	Lift force: 10,000N Speed: 37mm/sec Height adjustment (min to max): 487mm in 13 seconds Speed test load: 180kg
FOOTSWITCH	Ergonomic low profile design (20mm) Stainless steel Pneumatic control
SHIPPING	1930 x 730 x 720mm 125kg
WARRANTY	Structural: 15 years Hardware: 5 years Motor: 3 years Footswitch: 1 year Upholstery: To arrive in perfect condition

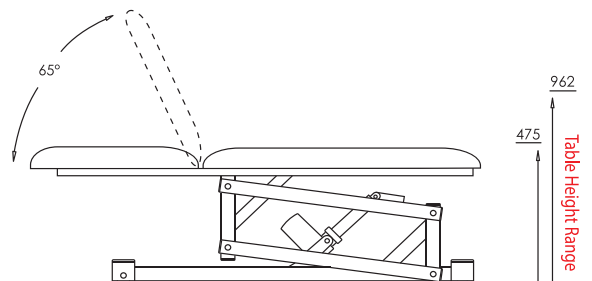

Athlegen is a brand of
Alevo Pty Ltd © 2019



All dimensions (shown in mm) and specifications are approximate and are subject to manufacturing tolerances.

#200305



"The table is perfect and I am really happy with the quality, material and colour. Your company made the whole process incredibly simple and efficient and delivered on time."

CAROLYN AUSTIN

Pro-Lift Treatment MB

Featuring a longer 730mm motorised backrest, this versatile table is suitable for a wide range of modalities, including physiotherapy, acupuncture, radiology, cardiology, beauty treatments or any multi-modality practice.

SELECT FROM OVER 30 COLOURS AND FABRIC CHOICES INCLUDING POLYURETHANE (PU), VINYL (PVC) AND GENUINE ITALIAN LEATHER:



PRODUCT INFORMATION



MOTORISED BACKREST

Reduce practitioner injury with a convenient motorised backrest for fast and effortless patient positioning.



OPTIONAL PATIENT SAFETY RAILS

Order safety rails on one or both sides of the table. Easy to fit and remove, safety rails provide additional safety during examinations or procedures.



FACE HOLE OPTIONS

Order with or without a face hole. Order a face hole plug to help move patients quickly between prone and supine positions - no need to rotate the patient to the other end of the table to avoid the face hole.



OPTIONAL SIDE SUPPORT

Provide additional patient support during procedures. Available in one or both sides. The side support is 610mm long and 210mm wide.



FOAM OPTIONS

Choose between five Dunlop® cushioning systems ranging from Ultra Firm to luxurious Viscoflex® slow release memory foam. We have the right foam system to suit your modality.



BASE STYLE

Choose between our Standard base with concealed in-line wheels and floor-leveling feet or our lockable Castor base for easy manoeuvrability. Also available with optional hospital-grade 100mm castors.

KEY OPTIONS

	STANDARD		OPTIONAL	
DUNLOP CUSHIONING	55mm, medium finish		Enduro (70mm, firm finish) Luxura (80mm, luxurious finish) Firm (50mm, firm finish) Ultra Firm (50mm, very firm finish)	
FACE HOLE	No face hole		In the backrest	
FACE HOLE PLUG	No face hole plug		Optional	
SAFETY RAILS	No rails		Single safety rail	Two safety rails
SIDE SUPPORT	No side support		Single side support	Twin side supports
BASE STYLE	Concealed in-line wheels	75mm locking castors	100mm hospital-grade castors	
HEIGHT FOOTSWITCH	Single		One on each side of the table	
BACKREST FOOTSWITCH	Single		One on each side of the table	
TABLE WIDTH	610mm	660mm	710mm	

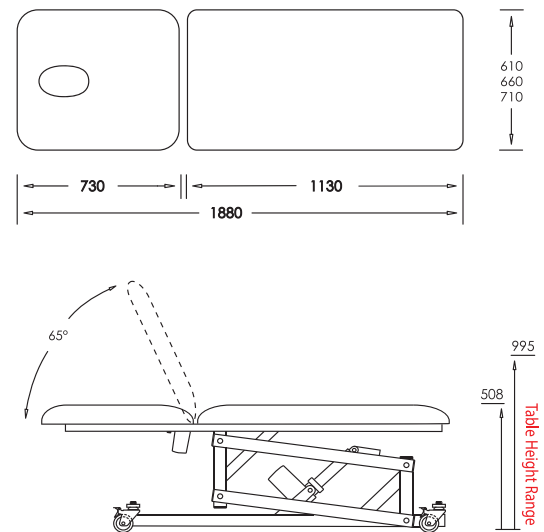

KEY SPECIFICATIONS

ADJUSTMENTS	Motorised backrest: +65°
SAFE WORKING LOAD	220kg
MOTOR	Lift force: 10,000N Speed: 37mm/sec Height adjustment (min to max): 487mm in 13 seconds Speed test load: 180kg
SECONDARY MOTOR	4,000N 11mm/sec
FOOTSWITCH	Ergonomic low profile design (20mm) Stainless steel Pneumatic control
SHIPPING	1930 x 730 x 720mm 125kg
WARRANTY	Structural: 15 years Hardware: 5 years Motor: 3 years Footswitch: 1 year Upholstery: To arrive in perfect condition

Athlegen is a brand of
Alevio Pty Ltd © 2019



All dimensions (shown in mm) and specifications are approximate and are subject to manufacturing tolerances.

#200305



"The table is perfect and I am really happy with the quality, material and colour. Your company made the whole process incredibly simple and efficient and delivered on time."

CAROLYN AUSTIN

Pro-Lift Treatment V

The versatile three section table features twin 680mm backrests which make this the ideal table for Dermatologists, Physiotherapists, General examination or multi-modality practices. The 680mm backrests allow for more legroom and both adjust to +65° (Fowler Position).

SELECT FROM OVER 30 COLOURS AND FABRIC CHOICES INCLUDING POLYURETHANE (PU), VINYL (PVC) AND GENUINE ITALIAN LEATHER:



PRODUCT INFORMATION



DUAL LIFT-UP BACK

The 680mm dual backrest configuration provides excellent supporting for taller patients, and has an adjustment range of +65° (Fowler position).



FACE HOLE OPTIONS

Choose a face recess in either or both backrest sections. Order a face hole plug to help move patients quickly between prone and supine positions - no need to rotate the patient to avoid the face hole.



OPTIONAL SIDE SUPPORT

Provide additional patient support during procedures. Available in one or both sides. The side support is 610mm long and 210mm wide.



FAST HEIGHT ADJUSTMENT

Save time with quick height adjustments from our extra powerful 10,000N German actuator - with smooth and quiet operation, our actuator is three times faster than most competing products.



TABLE WIDTH

Select from three table widths to suit your modality. Custom width tabletops are also available at an additional cost.



BASE STYLE

Choose between our Standard base with concealed in-line wheels and floor-levelling feet or our lockable Castor base for easy manoeuvrability. Also available with optional hospital-grade 100mm castors.

KEY OPTIONS

	STANDARD		OPTIONAL	
DUNLOP CUSHIONING	55mm, medium finish		Enduro (70mm, firm finish) Luxura (80mm, luxurious finish) Firm (50mm, firm finish) Ultra Firm (50mm, very firm finish)	
FACE HOLE	No face hole		In one backrest	In both backrests
FACE HOLE PLUG	No face hole plug		Optional	
SIDE SUPPORT	No side support		Single side support	Twin side supports
BASE STYLE	Concealed in-line wheels	75mm castors	100mm hospital-grade castors	
FOOTSWITCH	Single		One on each side of the table	
TABLE WIDTH	610mm	660mm	710mm	

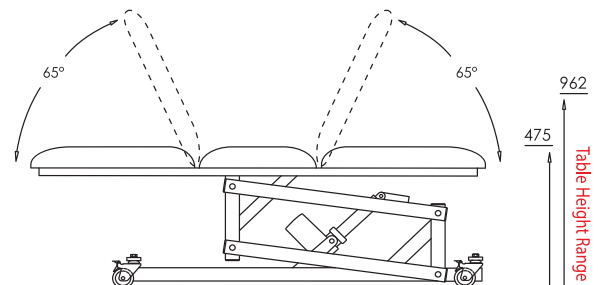
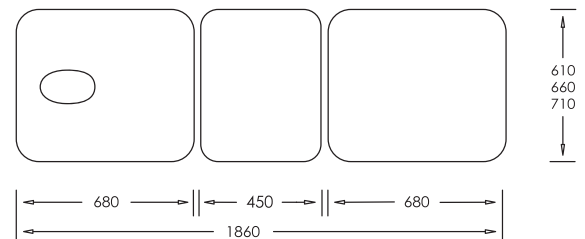

KEY SPECIFICATIONS

ADJUSTMENTS	Backrests: +65°
SAFE WORKING LOAD	220kg
MOTOR	Lift force: 10,000N Speed: 37mm/sec Height adjustment (min to max): 487mm in 13 seconds Speed test load: 180kg
FOOTSWITCH	Ergonomic low profile design (20mm) Stainless steel Pneumatic control
SHIPPING	1930 x 730 x 720mm 125kg
WARRANTY	Structural: 15 years Hardware: 5 years Motor: 3 years Footswitch: 1 year Upholstery: To arrive in perfect condition

Athlegen is a brand of
Alevo Pty Ltd © 2019



All dimensions (shown in mm) and specifications are approximate and are subject to manufacturing tolerances.

#200305



"The table is perfect and I am really happy with the quality, material and colour. Your company made the whole process incredibly simple and efficient and delivered on time."

CAROLYN AUSTIN

Pro-Lift Treatment X

The versatile three section table features twin 680mm backrests capable of +65° (Fowler Position) and -20° Trendelenber-like position). Designed specifically for Dermatologists this table is also suitable for a wide range of practitioners including Physiotherapists, General examination or multi-modality practices.

SELECT FROM OVER 30 COLOURS AND FABRIC CHOICES INCLUDING POLYURETHANE (PU), VINYL (PVC) AND GENUINE ITALIAN LEATHER:



PRODUCT INFORMATION



DUAL LIFT-UP BACK

The 680mm dual backrest configuration provides excellent supporting for taller patients, and has an adjustment range of +65° (Fowler position) to -20° (Trendelenburg-like position).

FACE HOLE OPTIONS

Order with or without a face hole. Order a face hole plug to help move patients quickly between prone and supine positions - no need to rotate the patient to the other end of the table to avoid the face hole.

OPTIONAL SIDE SUPPORT

Provide additional patient support during procedures. Available in one or both sides. The side support is 610mm long and 210mm wide.



FOAM OPTIONS

Choose between five Dunlop® cushioning systems ranging from Ultra Firm to luxurious Viscoflex® slow release memory foam. We have the right foam system to suit your modality.

TABLE WIDTH

Select from three table widths to suit your modality. Custom width tabletops are also available at an additional cost.

BASE STYLE

Choose between our Standard base with concealed in-line wheels and floor-levelling feet or our lockable Castor base for easy manoeuvrability. Also available with optional hospital-grade 100mm castors.

KEY OPTIONS

	STANDARD		OPTIONAL	
DUNLOP CUSHIONING	55mm, medium finish		Enduro (70mm, firm finish) Luxura (80mm, luxurious finish) Firm (50mm, firm finish) Ultra Firm (50mm, very firm finish)	
FACE HOLE	No face hole		In the backrest	
FACE HOLE PLUG	No face hole plug		Optional	
SIDE SUPPORT	No side support		Single side support	Twin side supports
BASE STYLE	Concealed in-line wheels	75mm locking castors	100mm hospital-grade castors	
FOOTSWITCH	Single		One on each side of the table	
TABLE WIDTH	610mm	660mm	710mm	

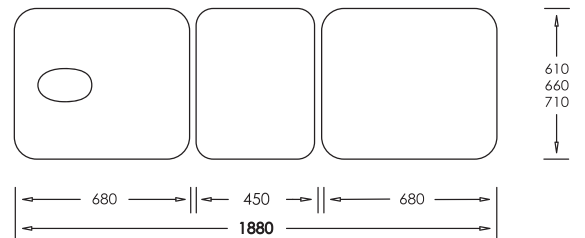

KEY SPECIFICATIONS

ADJUSTMENTS	Backrests: -20° to +65°
SAFE WORKING LOAD	220kg
MOTOR	Lift force: 10,000N Speed: 37mm/sec Height adjustment (min to max): 487mm in 13 seconds Speed test load: 180kg
FOOTSWITCH	Ergonomic low profile design (20mm) Stainless steel Pneumatic control
SHIPPING	1930 x 730 x 720mm 125kg
WARRANTY	Structural: 15 years Hardware: 5 years Motor: 3 years Footswitch: 1 year Upholstery: To arrive in perfect condition

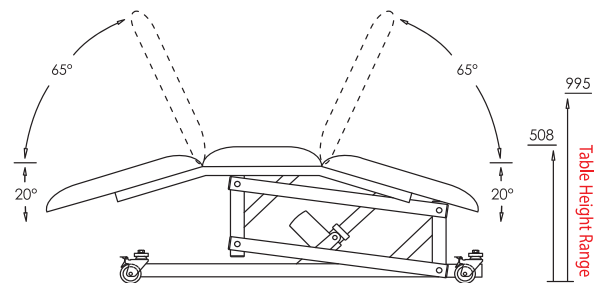

Athlegen is a brand of
Alevo Pty Ltd © 2019



All dimensions (shown in mm) and specifications are approximate and are subject to manufacturing tolerances.

#200305

Pro-Lift Dermatology Range

KEY FEATURES

TABLE	TREATMENT 680	TREATMENT ABR	TREATMENT MB	TREATMENT V	TREATMENT X
HEIGHT RANGE	475 to 962mm	475 to 962mm	508 to 995mm	475 to 962mm	508 to 995mm
TABLE LENGTH	1860mm	1860mm	1880mm	1860mm	1880mm
MANUAL BACKREST	●	●	×	●	●
MOTORISED BACKREST (4,000N)	×	×	●	×	×
DUAL BACKREST (+65°)	×	×	×	●	×
DUAL BACKREST (+65° TO -20°)	×	×	×	×	●
ADJUSTABLE HEAD SECTION	●	×	×	×	×
FACE HOLE	●	○	○	○	○
SIDE SUPPORT	×	×	○	○	○
PATIENT SAFETY RAILS	×	×	○	×	×

MOTOR

LIFT FORCE	10,000N
SPEED	37mm/sec
HEIGHT ADJUSTMENT (MIN TO MAX)	487mm in 13 secs
SAFE WORKING LOAD	220kg

SECONDARY MOTOR (TREATMENT MB)

LIFT FORCE	4,000N
SPEED	11mm/sec
SAFE WORKING LOAD	220kg

TABLE	680	ABR	MB	V	X
FOOTSWITCH	●	●	●	●	●
ADDITIONAL FOOTSWITCH	○	○	○	○	○

TABLE WIDTH

STANDARD	610 or 660mm	610 or 660mm	610 or 660mm	610 or 660mm	610 or 660mm
OPTIONAL	710mm	710mm	710mm	710mm	710mm

DUNLOP CUSHIONING

STANDARD	●	●	●	●	●
ENDURO	○	○	○	○	○
LUXURA	○	○	○	○	○
FIRM	○	○	○	○	○
ULTRA FIRM	○	○	○	○	○

UPHOLSTERY

TABLE	680	ABR	MB	V	X
EVOLVE PU	●	●	●	●	●
ENCORE PVC	●	●	●	●	●
ULTRA PU	○	○	○	○	○
ULTIMATE PVC	○	○	○	○	○
GENUINE ITALIAN LEATHER	○	○	○	○	○

BASE STYLE

STANDARD BASE WITH IN-LINE WHEELS & LEVELLING FEET	●	●	●	●	●
75MM LOCKING CASTOR BASE	○	○	●	●	●
100MM HOSPITAL GRADE CASTORS	×	×	○	○	○

WARRANTY

STRUCTURAL	15 years
HARDWARE	5 years
MOTOR	3 years
FOOTSWITCH	1 year
UPHOLSTERY	To arrive in perfect condition
MOTOR WARRANTY UPGRADE (5 OR 10 YEARS)	○

OPTIONAL EXTRAS

DISPOSABLE FACE CRADLE COVERS
DISPOSABLE TABLE COVER
FITTED TERRY TOWELLING COVER
SUPINE PAD
LEG BOLSTER
ADDITIONAL FOOTSWITCH

KEY

● STANDARD
○ OPTIONAL
× NOT APPLICABLE

