

ATHLEGEN

Echocardiography Range



1800 813 000
www.athlegen.com.au
sales@athlegen.com



"The table is perfect and I am really happy with the quality, material and colour. Your company made the whole process incredibly simple and efficient and delivered on time."

CAROLYN AUSTIN

Pro-Lift Treatment ABR

With a lift-up back, this versatile table is suitable for a wide range of modalities, including physio, acupuncture, massage, beauty treatments, examinations, or any multimodality practice.

SELECT FROM OVER 30 COLOURS AND FABRIC CHOICES INCLUDING POLYURETHANE (PU), VINYL (PVC) AND GENUINE ITALIAN LEATHER:



PRODUCT INFORMATION



MANUALLY ADJUSTABLE BACKREST

The Treatment ABR adjusts flat in seconds to create a sturdy, comfortable treatment platform. This versatile table is an ideal choice for massage or beauty treatments, examinations or any multimodality practice.

FAST HEIGHT ADJUSTMENT

Save time with quick height adjustments from our extra powerful 10,000N German actuator - with smooth and quiet operation, our actuator is three times faster than most competing products.

FACE HOLE OPTIONS

Choose a face recess in the lift-up back or main body section. Order a face hole plug to help move patients quickly between prone and supine positions - no need to rotate the patient to avoid the face hole.



FOAM OPTIONS

Choose between five Dunlop® cushioning systems ranging from Ultra Firm to luxurious Viscoflex® slow release memory foam. We have the right foam system to suit your modality.

TABLE WIDTH

Select from three table widths to suit your modality. Custom width tabletops are also available at an additional cost.

BASE STYLE

Choose between our Standard base with concealed in-line wheels and floor-levelling feet or our lockable Castor base for easy manoeuvrability. All wheels feature TPE rubber compound tread to protect your floors.

KEY OPTIONS

	STANDARD	OPTIONAL
DUNLOP CUSHIONING	55mm, medium finish	Enduro (70mm, firm finish) Luxura (80mm, luxurious finish) Firm (50mm, firm finish) Ultra Firm (50mm, very firm finish)
BACKREST	Manually adjustable	N/A
FACE HOLE	No face hole	In the main body In the lift-up back
FACE HOLE PLUG	No face hole plug	Optional
BASE STYLE	Concealed in-line wheels	75mm locking castors
FOOTSWITCH	Single	One on each side of the table
TABLE WIDTH	610mm 660mm	710mm

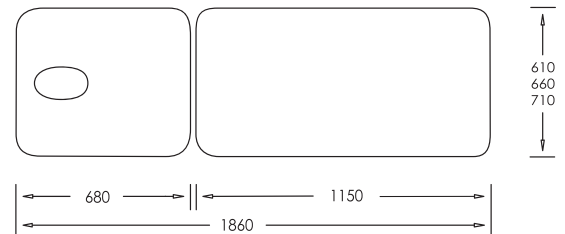

KEY SPECIFICATIONS

ADJUSTMENTS	Backrest: +65°
SAFE WORKING LOAD	220kg
MOTOR	Lift force: 10,000N Speed: 37mm/sec Height adjustment (min to max): 487mm in 13 seconds Speed test load: 180kg
FOOTSWITCH	Ergonomic low profile design (20mm) Stainless steel Pneumatic control
SHIPPING	1930 x 730 x 720mm 125kg
WARRANTY	Structural: 15 years Hardware: 5 years Motor: 3 years Footswitch: 1 year Upholstery: To arrive in perfect condition

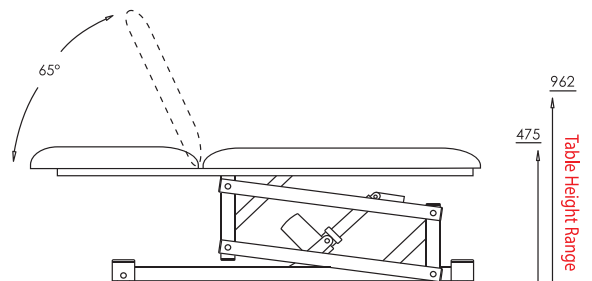

Athlegen is a brand of
Alevo Pty Ltd © 2019



All dimensions (shown in mm) and specifications are approximate and are subject to manufacturing tolerances.

#200305



"The table is perfect and I am really happy with the quality, material and colour. Your company made the whole process incredibly simple and efficient and delivered on time."

CAROLYN AUSTIN

Pro-Lift Treatment MB

Featuring a longer 730mm motorised backrest, this versatile table is suitable for a wide range of modalities, including physiotherapy, acupuncture, radiology, cardiology, beauty treatments or any multi-modality practice.

SELECT FROM OVER 30 COLOURS AND FABRIC CHOICES INCLUDING POLYURETHANE (PU), VINYL (PVC) AND GENUINE ITALIAN LEATHER:



PRODUCT INFORMATION



MOTORISED BACKREST

Reduce practitioner injury with a convenient motorised backrest for fast and effortless patient positioning.



OPTIONAL PATIENT SAFETY RAILS

Order safety rails on one or both sides of the table. Easy to fit and remove, safety rails provide additional safety during examinations or procedures.



FACE HOLE OPTIONS

Order with or without a face hole. Order a face hole plug to help move patients quickly between prone and supine positions - no need to rotate the patient to the other end of the table to avoid the face hole.



OPTIONAL SIDE SUPPORT

Provide additional patient support during procedures. Available in one or both sides. The side support is 610mm long and 210mm wide.



FOAM OPTIONS

Choose between five Dunlop® cushioning systems ranging from Ultra Firm to luxurious Viscoflex® slow release memory foam. We have the right foam system to suit your modality.



BASE STYLE

Choose between our Standard base with concealed in-line wheels and floor-levelling feet or our lockable Castor base for easy manoeuvrability. Also available with optional hospital-grade 100mm castors.

KEY OPTIONS

	STANDARD		OPTIONAL	
DUNLOP CUSHIONING	55mm, medium finish		Enduro (70mm, firm finish) Luxura (80mm, luxurious finish) Firm (50mm, firm finish) Ultra Firm (50mm, very firm finish)	
FACE HOLE	No face hole		In the backrest	
FACE HOLE PLUG	No face hole plug		Optional	
SAFETY RAILS	No rails		Single safety rail	Two safety rails
SIDE SUPPORT	No side support		Single side support	Twin side supports
BASE STYLE	Concealed in-line wheels	75mm locking castors	100mm hospital-grade castors	
HEIGHT FOOTSWITCH	Single		One on each side of the table	
BACKREST FOOTSWITCH	Single		One on each side of the table	
TABLE WIDTH	610mm	660mm	710mm	

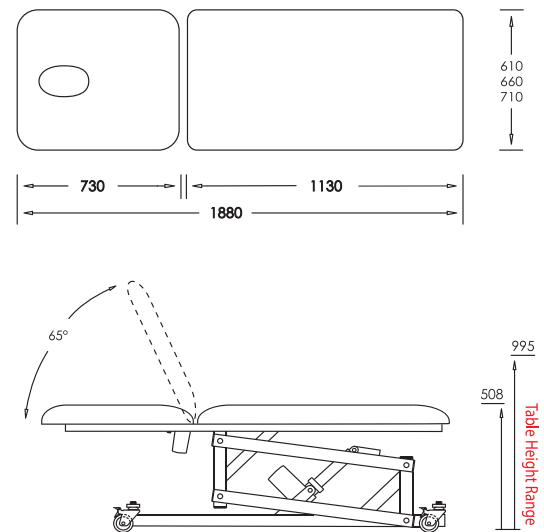

KEY SPECIFICATIONS

ADJUSTMENTS	Motorised backrest: +65°
SAFE WORKING LOAD	220kg
MOTOR	Lift force: 10,000N Speed: 37mm/sec Height adjustment (min to max): 487mm in 13 seconds Speed test load: 180kg
SECONDARY MOTOR	4,000N 11mm/sec
FOOTSWITCH	Ergonomic low profile design (20mm) Stainless steel Pneumatic control
SHIPPING	1930 x 730 x 720mm 125kg
WARRANTY	Structural: 15 years Hardware: 5 years Motor: 3 years Footswitch: 1 year Upholstery: To arrive in perfect condition

Athlegen is a brand of
Alevio Pty Ltd © 2019



All dimensions (shown in mm) and specifications are approximate and are subject to manufacturing tolerances.

#200305



"The table is perfect and I am really happy with the quality, material and colour. Your company made the whole process incredibly simple and efficient and delivered on time."

CAROLYN AUSTIN

Pro-Lift Echo MB1

Specifically designed to reduce sonographer fatigue this echocardiography table features a 730mm motorised backrest with a hinged cardiac section which easily stows away with a convenient magnetic lock, for fast unobtrusive imaging access. Designed in conjunction with leading industry professionals.

SELECT FROM OVER 30 COLOURS AND FABRIC CHOICES INCLUDING POLYURETHANE (PU), VINYL (PVC) AND GENUINE ITALIAN LEATHER:



PRODUCT INFORMATION



MOTORISED BACKREST

Reduce practitioner injury with a convenient motorised backrest for fast and effortless patient positioning.



ECHO FILL-IN PAD

The echo fill-in pad conveniently stows away with a magnetic catch for unobstructed imaging. The echo fill-in pad is 260mm long and 180mm wide.



OPTIONAL PATIENT SAFETY RAILS

Order safety rails on one or both sides of the table. Easy to fit and remove, safety rails provide additional safety during examinations or procedures.



FOAM OPTIONS

Choose between three Dunlop® cushioning systems ranging from premium Enduro® long-lasting medium finish foam to luxurious Viscoflex® slow release memory foam. We have the right foam system to suit you.



FACE HOLE OPTIONS

Order with or without a face hole. Order a face hole plug to help move patients quickly between prone and supine positions - no need to rotate the patient to the other end of the table to avoid the face hole.



BASE STYLE

Standard with 75mm lockable castors for easy manoeuvrability. Also available with hospital-grade 100mm lockable castors. All wheels feature TPE rubber compound tread to protect your floors.

KEY OPTIONS

	STANDARD	OPTIONAL
DUNLOP CUSHIONING	55mm, medium finish	Enduro (70mm, firm finish) Luxura (80mm, luxurious finish)
FACE HOLE	No face hole	In the backrest
FACE HOLE PLUG	No face hole plug	Optional
SAFETY RAILS	No rails	Single safety rail Two safety rails
BASE STYLE	75mm locking castors	100mm hospital-grade castors
HEIGHT FOOTSWITCH	Single	One on each side of the table
BACKREST FOOTSWITCH	Single	One on each side of the table
TABLE WIDTH	710mm	N/A

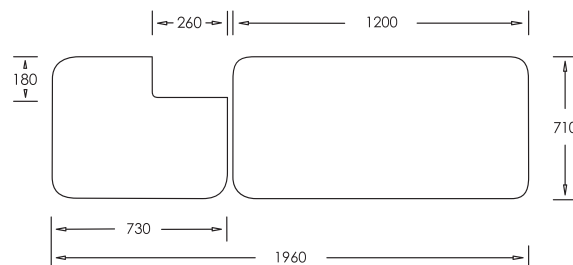

KEY SPECIFICATIONS

ADJUSTMENTS	Manually adjustable echo fill-in pad: 260 x 180mm Motorised backrest: +65°
SAFE WORKING LOAD	220kg
MOTOR	Lift force: 10,000N Speed: 37mm/sec Height adjustment (min to max): 487mm in 13 seconds Speed test load: 180kg
SECONDARY MOTOR	Lift force: 4,000N Speed: 11mm/sec
FOOTSWITCH	Ergonomic low profile design (20mm) Stainless steel Pneumatic control
SHIPPING	1930 x 730 x 720mm 125kg
WARRANTY	Structural: 15 years Hardware: 5 years Motor: 3 years Footswitch: 1 year Upholstery: To arrive in perfect condition

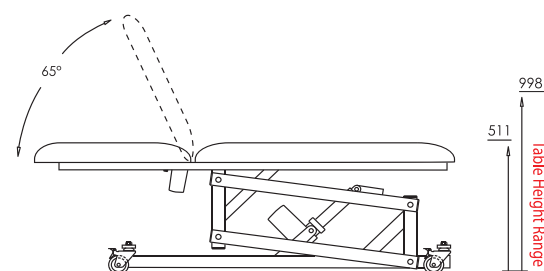

Athlegen is a brand of
Alevo Pty Ltd © 2019



All dimensions (shown in mm) and specifications are approximate and are subject to manufacturing tolerances.

#200305



"The table is perfect and I am really happy with the quality, material and colour. Your company made the whole process incredibly simple and efficient and delivered on time."

CAROLYN AUSTIN

Pro-Lift Echo MB2

Designed in conjunction with Radiologists this echocardiography table features a 680mm motorised backrest with a hinged cardiac section in the main body section which easily stows away with a convenient magnetic lock, for fast unobtrusive imaging access.

SELECT FROM OVER 30 COLOURS AND FABRIC CHOICES INCLUDING POLYURETHANE (PU), VINYL (PVC) AND GENUINE ITALIAN LEATHER:



PRODUCT INFORMATION



MOTORISED BACKREST

Reduce practitioner injury with a convenient motorised backrest for fast and effortless patient positioning.



ECHO FILL-IN PAD

The echo fill-in pad conveniently stows away with a magnetic catch for unobstructed imaging. The echo fill-in pad is 260mm long and 180mm wide.



OPTIONAL PATIENT SAFETY RAILS

Order safety rails on one or both sides of the table. Easy to fit and remove, safety rails provide additional safety during examinations or procedures.



TABLE WIDTH

Select from two table width options to suit your practice. The narrower 660mm width options allow easier practitioner access while the luxurious 710mm width option improves patient comfort and stability.



FOAM OPTIONS

Choose between three Dunlop® cushioning systems ranging from premium Enduro® long-lasting medium finish foam to luxurious Viscoflex® slow release memory foam. We have the right foam system to suit you.



BASE STYLE

Standard with 75mm lockable castors for easy manoeuvrability. Also available with hospital-grade 100mm lockable castors. All wheels feature TPE rubber compound tread to protect your floors.

KEY OPTIONS

	STANDARD	OPTIONAL
DUNLOP CUSHIONING	55mm, medium finish	Enduro (70mm, firm finish) Luxura (80mm, luxurious finish)
SAFETY RAILS	No rails	Single safety rail Two safety rails
BASE STYLE	75mm locking castors	100mm hospital-grade castors
HEIGHT FOOTSWITCH	Single	One on each side of the table
BACKREST FOOTSWITCH	Single	One on each side of the table
TABLE WIDTH	660mm	710mm

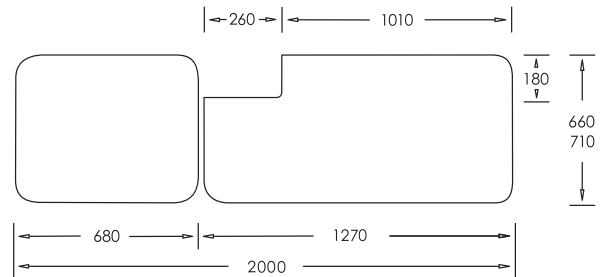

KEY SPECIFICATIONS

ADJUSTMENTS	Motorised backrest: +65° Manually adjustable echo fill-in pad: 260 x 180mm Not available with a face hole
SAFE WORKING LOAD	220kg
MOTOR	Lift force: 10,000N Speed: 37mm/sec Height adjustment (min to max): 487mm in 13 seconds Speed test load: 180kg
SECONDARY MOTOR	Lift force: 4,000N Speed: 11mm/sec
FOOTSWITCH	Ergonomic low profile design (20mm) Stainless steel Pneumatic control
SHIPPING	1930 x 730 x 720mm 125kg
WARRANTY	Structural: 15 years Hardware: 5 years Motor: 3 years Footswitch: 1 year Upholstery: To arrive in perfect condition

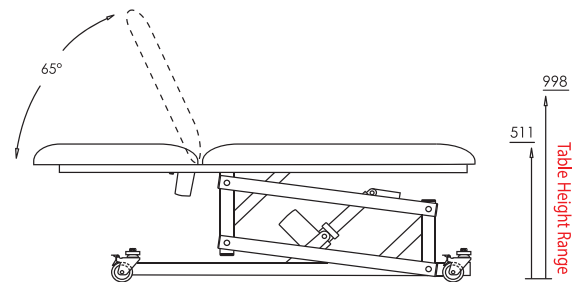

Athlegen is a brand of
Alevio Pty Ltd © 2019



All dimensions (shown in mm) and specifications are approximate and are subject to manufacturing tolerances.

#200305



"The table is perfect and I am really happy with the quality, material and colour. Your company made the whole process incredibly simple and efficient and delivered on time."

CAROLYN AUSTIN

Pro-Lift Echo SB

Designed in conjunction with Radiologists this entry-level echocardiography table features a 680mm manually adjustable backrest with a hinged cardiac section in the main body section which easily stows away with a convenient magnetic lock, for fast unobtrusive imaging access.

SELECT FROM OVER 30 COLOURS AND FABRIC CHOICES INCLUDING POLYURETHANE (PU), VINYL (PVC) AND GENUINE ITALIAN LEATHER:



PRODUCT INFORMATION



OPTIONAL MOTORISED BACKREST

Reduce practitioner injury with a convenient motorised backrest for fast and effortless patient positioning.



ECHO FILL-IN PAD

The echo fill-in pad conveniently stows away with a magnetic catch for unobstructed imaging. The echo fill-in pad is 260mm long and 180mm wide.



OPTIONAL PATIENT SAFETY RAILS

Order safety rails on one or both sides of the table. Easy to fit and remove, safety rails provide additional safety during examinations or procedures.



TABLE WIDTH

Select from two table width options to suit your practice. The narrower 660mm width options allow easier practitioner access while the luxurious 710mm width option improves patient comfort and stability.

FOAM OPTIONS

Choose between three Dunlop® cushioning systems ranging from premium Enduro® long-lasting medium finish foam to luxurious Viscoflex® slow release memory foam. We have the right foam system to suit you.

BASE STYLE

Standard with 75mm lockable castors for easy manoeuvrability. Also available with hospital-grade 100mm lockable castors. All wheels feature TPE rubber compound tread to protect your floors.

KEY OPTIONS

	STANDARD	OPTIONAL
DUNLOP CUSHIONING	55mm, medium finish	Enduro (70mm, firm finish) Luxura (80mm, luxurious finish)
MOTORISED BACKREST	Manually adjustable	Motorised
SAFETY RAILS	No rails	Single safety rail Two safety rails
BASE STYLE	75mm locking castors	100mm hospital-grade castors
FOOTSWITCH	Single	One on each side of the table
TABLE WIDTH	660mm	710mm

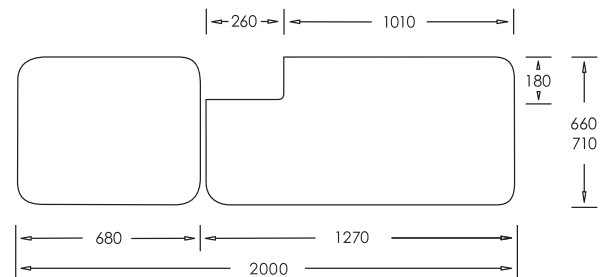

KEY SPECIFICATIONS

ADJUSTMENTS	Manually adjustable backrest: +65° Manually adjustable echo fill-in pad: 260 x 180mm Not available with a face hole
SAFE WORKING LOAD	220kg
MOTOR	Lift force: 10,000N Speed: 37mm/sec Height adjustment (min to max): 487mm in 13 seconds Speed test load: 180kg
FOOTSWITCH	Ergonomic low profile design (20mm) Stainless steel Pneumatic control
SHIPPING	1930 x 730 x 720mm 125kg
WARRANTY	Structural: 15 years Hardware: 5 years Motor: 3 years Footswitch: 1 year Upholstery: To arrive in perfect condition

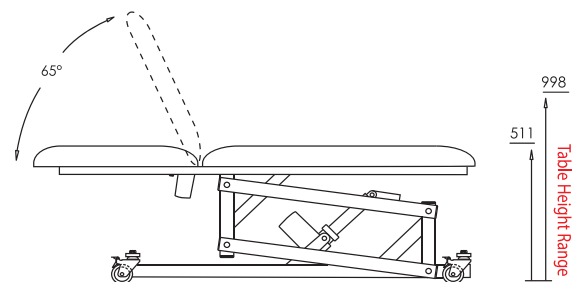

Athlegen is a brand of
Alvo Pty Ltd © 2019



All dimensions (shown in mm) and specifications are approximate and are subject to manufacturing tolerances.

#200305

Pro-Lift Echocardiography Range

KEY FEATURES

TABLE	TREATMENT ABR	TREATMENT MB	ECHO MB1	ECHO MB2	ECHO SB
HEIGHT RANGE	475 to 962mm	508 to 995mm	511 to 998mm	511 to 998mm	511 to 998mm
TABLE LENGTH	1860mm	1880mm	1960mm	2000mm	2000mm
MANUAL BACKREST	●	x	x	x	●
MOTORISED BACKREST	x	●	●	●	○
FACE HOLE	○	○	○	x	x
ECHO FILL-IN PAD	x	x	●	●	●
SIDE SUPPORT	x	○	x	x	x
PATIENT SAFETY RAILS	x	○	○	○	○

MOTOR

TABLE	ABR	MB	MB1	MB2	SB
LIFT FORCE	10,000N	10,000N	10,000N	10,000N	10,000N
SPEED	37mm/sec	37mm/sec	37mm/sec	37mm/sec	37mm/sec
HEIGHT ADJUSTMENT (MIN TO MAX)	487mm in 13 secs	487mm in 13 secs	487mm in 13 secs	487mm in 13 secs	487mm in 13 secs
SAFE WORKING LOAD	220kg	220kg	220kg	220kg	220kg

BASE STYLE

TABLE	ABR	MB	MB1	MB2	SB
STANDARD BASE WITH IN-LINE WHEELS & LEVELLING FEET	●	●	x	x	x
75MM LOCKING CASTOR BASE	○	●	●	●	●
100MM HOSPITAL GRADE CASTORS	x	○	○	○	○

SECONDARY MOTOR

LIFT FORCE	N/A	4,000N	4,000N	4,000N	4,000N
SPEED	N/A	11mm/sec	11mm/sec	11mm/sec	11mm/sec
FOOTSWITCH	●	●	●	●	●
ADDITIONAL FOOTSWITCH	○	○	○	○	○

WARRANTY

STRUCTURAL	15 years	15 years	15 years	15 years	15 years
HARDWARE	5 years	5 years	5 years	5 years	5 years
MOTOR	3 years	3 years	3 years	3 years	3 years
FOOTSWITCH	1 year	1 year	1 year	1 year	1 year
UPHOLSTERY	To arrive in perfect condition	To arrive in perfect condition	To arrive in perfect condition	To arrive in perfect condition	To arrive in perfect condition
MOTOR WARRANTY UPGRADE (5 OR 10 YEARS)	○	○	○	○	○

TABLE WIDTH

STANDARD	610 or 660mm	610 or 660mm	710mm	660mm	660mm
OPTIONAL	710mm	710mm	N/A	710mm	710mm

DUNLOP CUSHIONING

STANDARD	●	●	●	●	●
ENDURO	○	○	○	○	○
LUXURA	○	○	○	○	○
FIRM	○	○	x	x	x
ULTRA FIRM	○	○	x	x	x

UPHOLSTERY

EVOLVE PU	●	●	●	●	●
ENCORE PVC	●	●	●	●	●
ULTRA PU	○	○	○	○	○
ULTIMATE PVC	○	○	○	○	○
GENUINE ITALIAN LEATHER	○	○	○	○	○

OPTIONAL EXTRAS

DISPOSABLE FACE CRADLE COVERS
DISPOSABLE TABLE COVER
FITTED TERRY TOWELLING COVER
SUPINE PAD
LEG BOLSTER
ADDITIONAL FOOTSWITCH

KEY

● STANDARD
○ OPTIONAL
x NOT APPLICABLE

